

DO NOT SCALE

| Rev | Date | Amendment |
|-----|------|-----------|
|     |      |           |

## 01 TYPICAL MONOSLOPE FORMATION

SHT - 1:20 @ A3 (SHOWING CUT AND FILL)

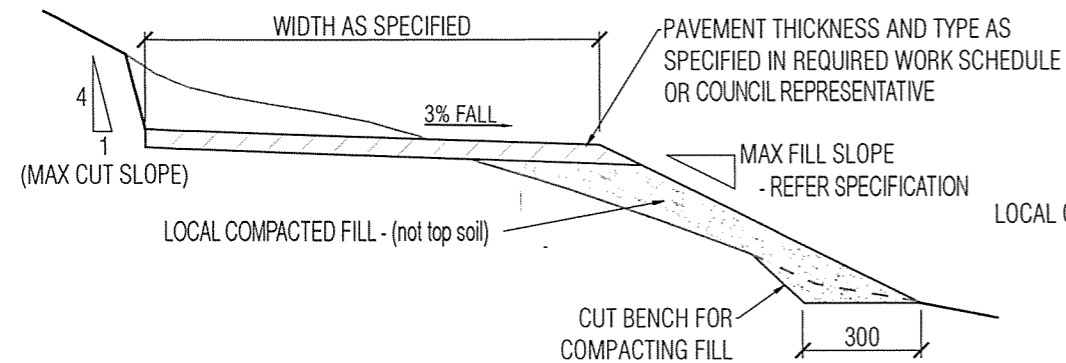

## 03A EDGE BOARD DETAIL

SHT - 1:20 @ A3

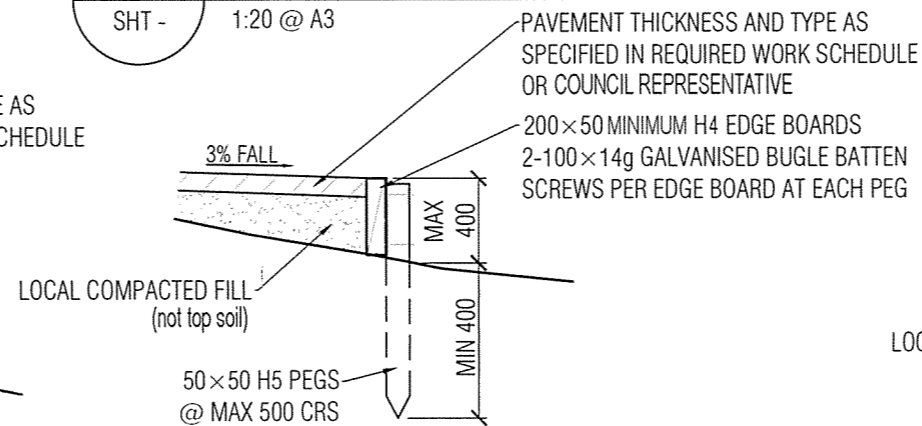

## 03B EDGE BOARD DETAIL

SHT - 1:20 @ A3

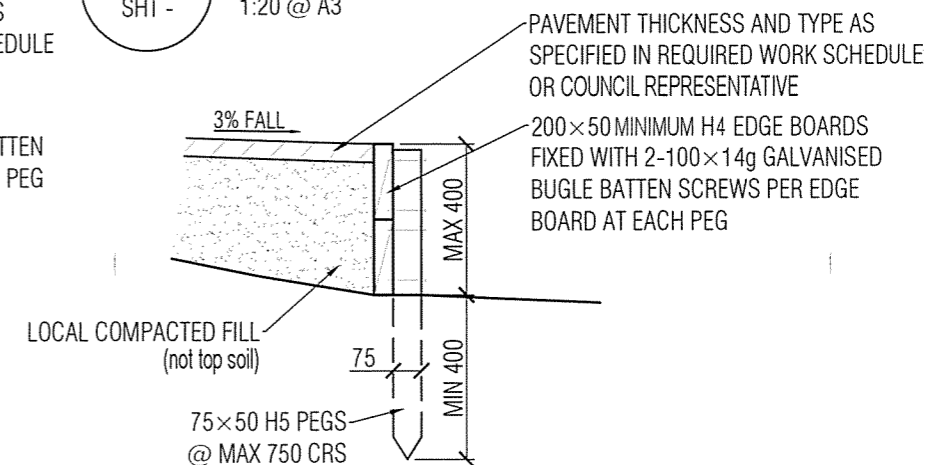

## 01A TYPICAL MONOSLOPE FORMATION

SHT - 1:20 @ A3 (SHOWING FULL BENCH CUT)

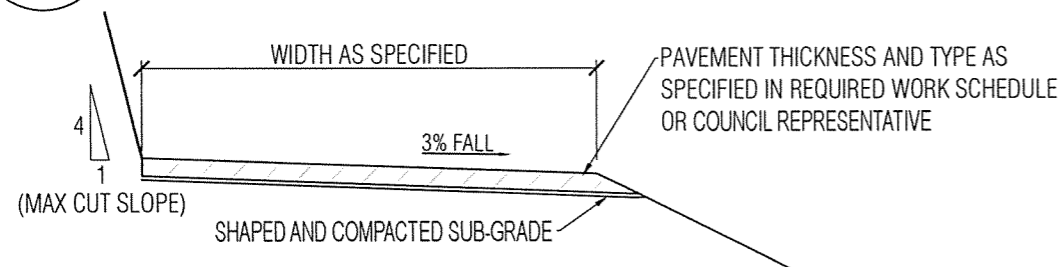

## 03C EDGE BOARD DETAIL

SHT - 1:20 @ A3

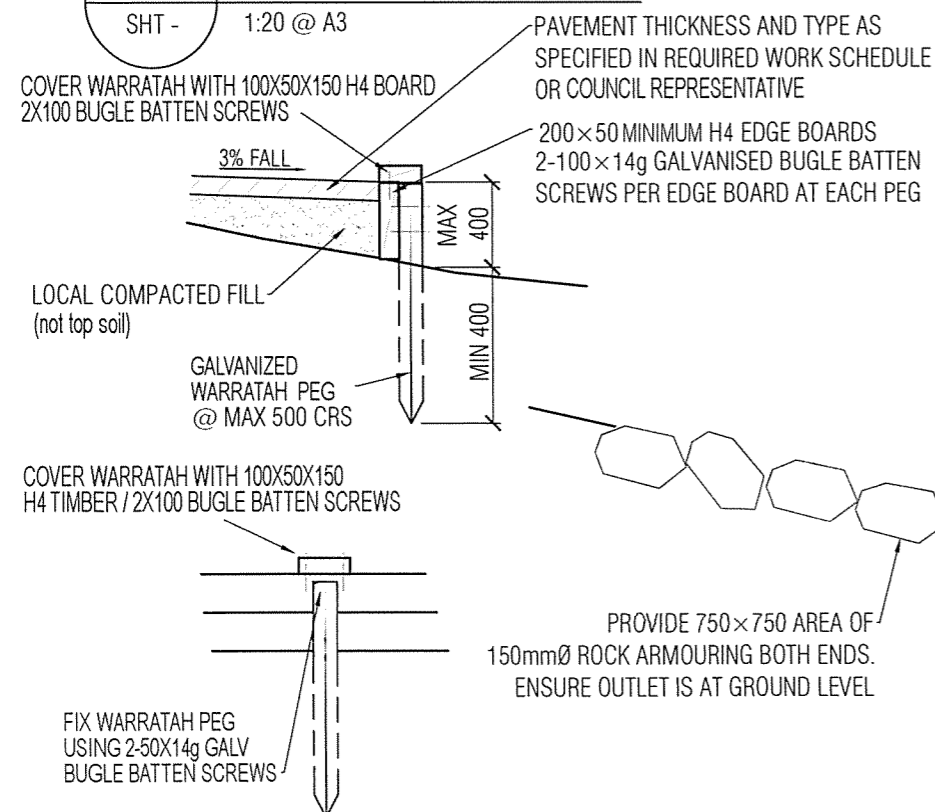

## 02 TYPICAL CROWNED FORMATION WITH DRAINAGE CULVERT

SHT - 1:10 @ A3 (SHOWING FULL CUT)

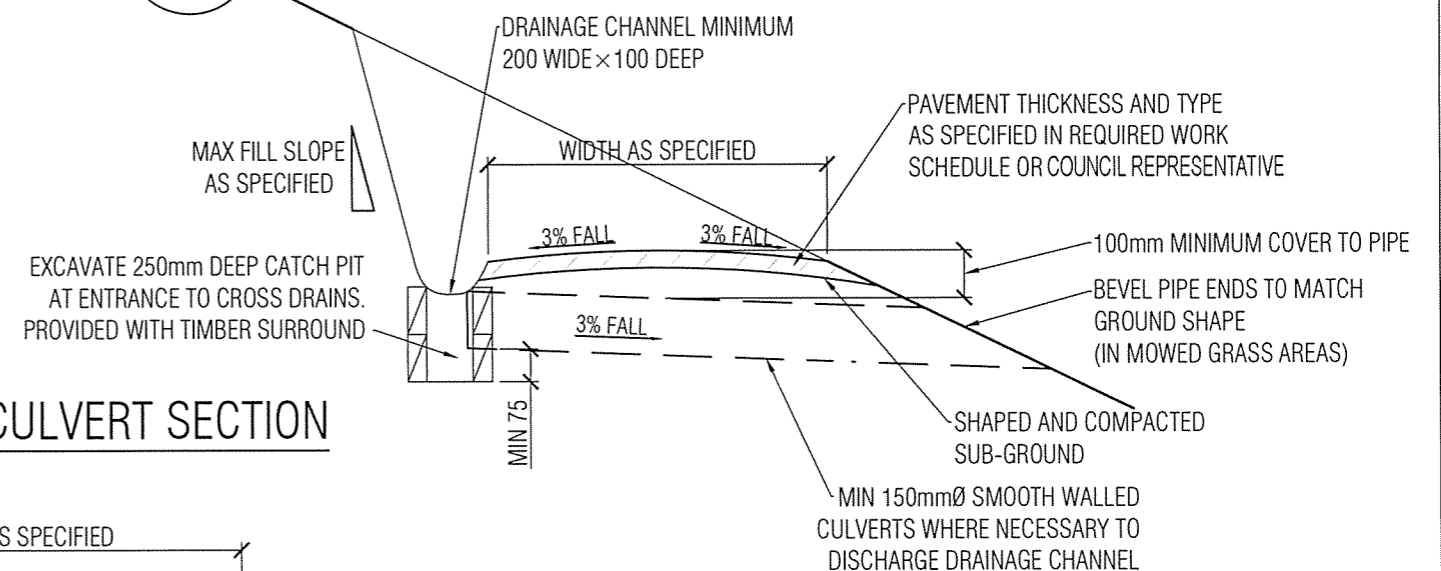

## 04 TYPICAL CULVERT SECTION

SHT - 1:20 @ A3

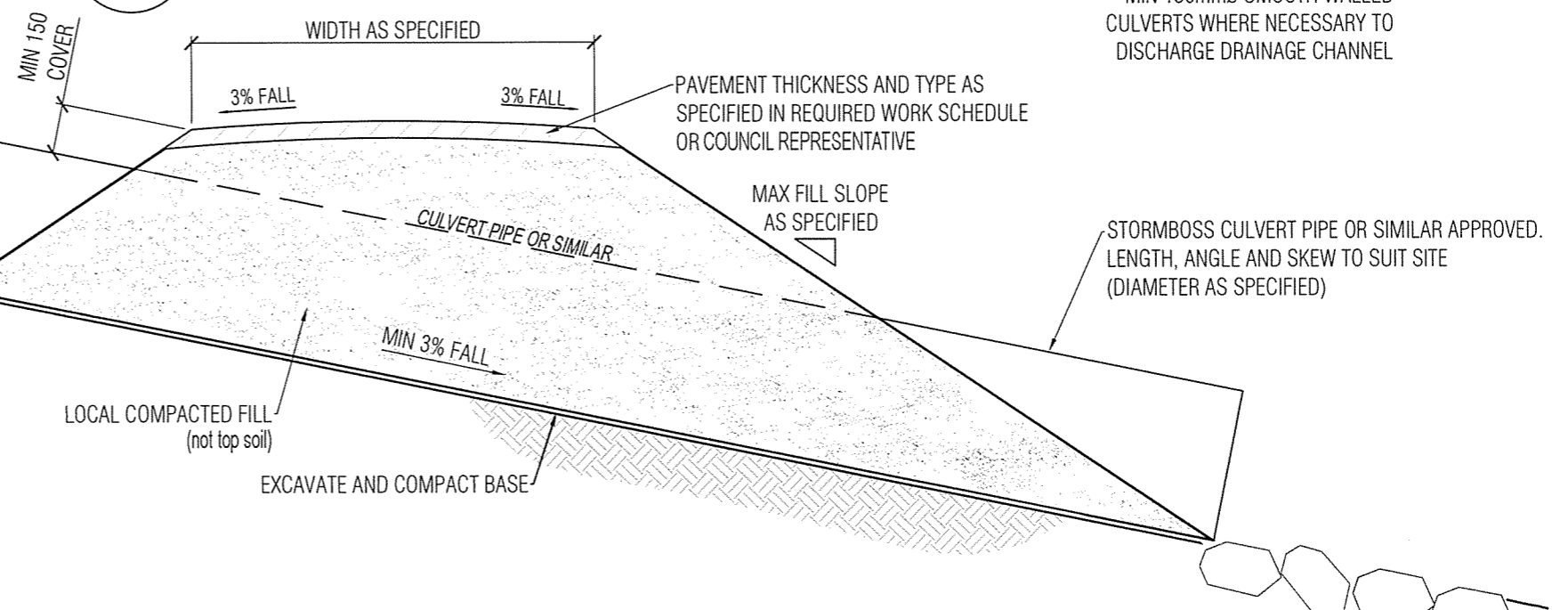

DO NOT SCALE

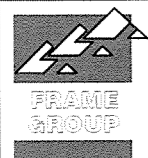

### Frame Group Limited

PO BOX 147211, PONSONBY, AUCKLAND 1144  
LEVEL 2, 16 COLLEGE HILL, AUCKLAND, NZ  
PHONE: 09 638 7221  
© FRAME GROUP LTD 2017

PREPARED FOR

Absolutely Positively  
Wellington City Council  
Mr Heke Ri Pōneke

PROJECT

STANDARD DRAWINGS  
DRAWINGS REFLECT FRAME GROUP DRAFT DRAWINGS WITH  
WCC MODIFICATIONS WHERE APPLICABLE

TITLE

TYPICAL TRACK  
CONSTRUCTION DETAILS

SCALE

AS SHOWN

DATE

DECEMBER 2017

DRAWN

JR

DESIGNED

FGL JOB

06/113

APPROVED

DRAWING

17/096 SHT 01

REV

DO NOT SCALE

| Rev | Date | Amendment |
|-----|------|-----------|
|     |      |           |

01

RETAINING WALL DETAIL

SHT -

1:20 @ A3

(UPSLOPE AND DOWNSLOPE WALLS  
MAY BE CONSTRUCTED SEPARATELY OR TOGETHER)

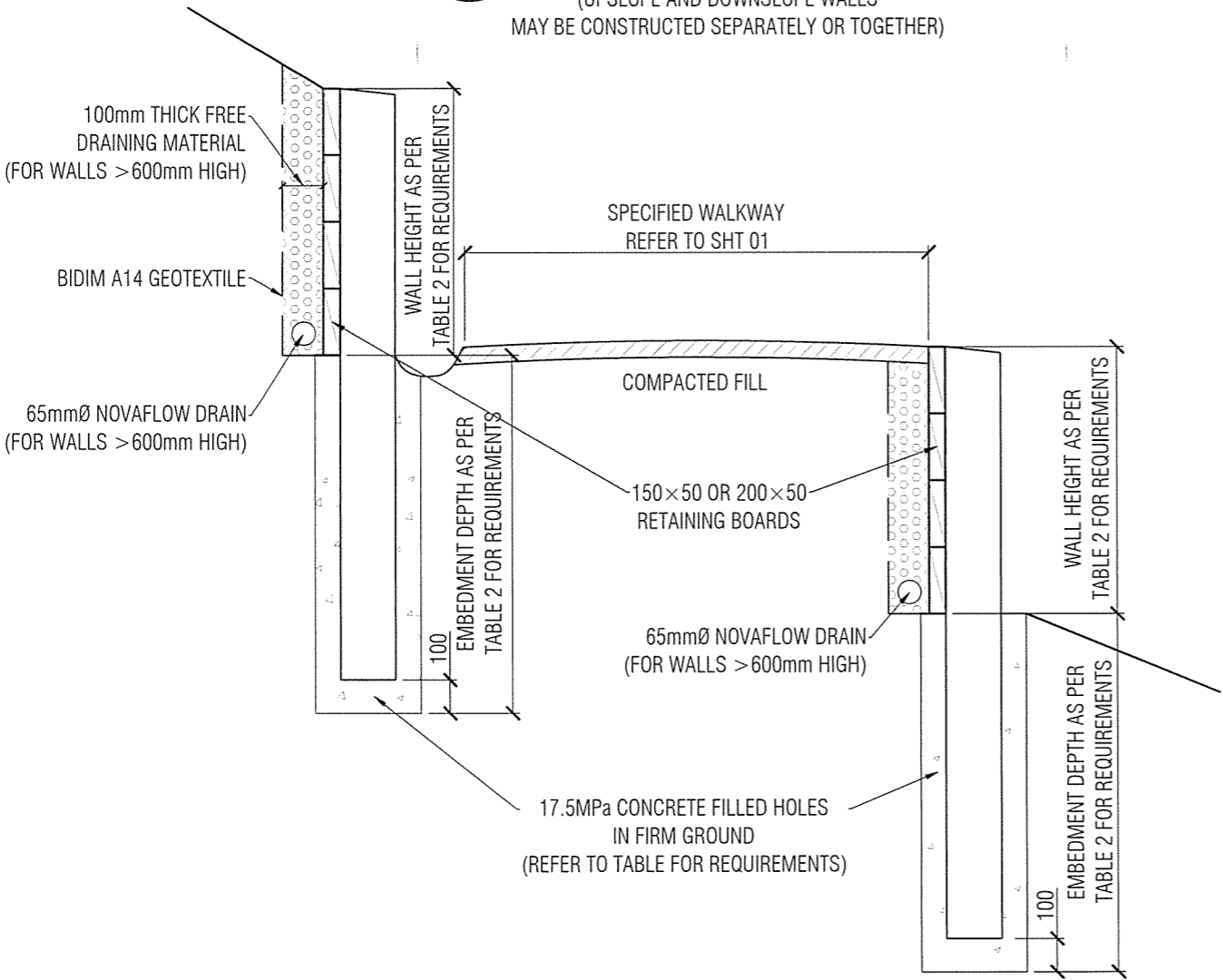

| TABLE 2 - RETAINING WALL DETAILS (mm) |               |               |              |                 |
|---------------------------------------|---------------|---------------|--------------|-----------------|
| MAX WALL HEIGHT                       | POST DIAMETER | HOLE DIAMETER | POST CENTRES | EMBEDMENT DEPTH |
| 400                                   | 125           | 275           | 1800         | 900             |
| 600                                   | 125           | 275           | 1200         | 1000            |
| 750                                   | 125           | 275           | 900          | 1200            |
| 900                                   | 150           | 300           | 1200         | 1500            |
| 1200                                  | 150           | 300           | 900          | 1800            |

NOTE:  
RETAINING WALL EMBEDMENT DEPTHS ARE GIVEN FOR FIRM GROUND. IF POOR GROUND SURFACE IS PRESENT, WALL DIMENSIONS AND EMBEDMENT DEPTH SHALL BE TAKEN FROM WALL HEIGHT PLUS THE DEPTH OF POOR SURFACE MATERIAL.

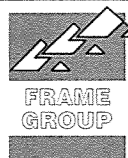

**Frame Group Limited**  
PO BOX 147211, PONSONBY, AUCKLAND 1144  
LEVEL 2, 16 COLLEGE HILL, AUCKLAND, NZ  
PHONE: 09 638 7221  
© FRAME GROUP LTD, 2017

PREPARED FOR  
**Absolutely Positively**  
**Wellington City Council**  
*Me Hōke Kō Pōneke*

PROJECT

STANDARD DRAWINGS

TITLE

RETAINING WALL  
CONSTRUCTION DETAILS

|                   |          |                          |     |
|-------------------|----------|--------------------------|-----|
| SCALE<br>AS SHOWN |          | DATE<br>DECEMBER 2017    |     |
| DRAWN<br>JR       | DESIGNED | FGL JOB<br>06/113        |     |
| APPROVED          |          | DRAWING<br>17/096 SHT 04 | REV |

DO NOT SCALE

01

## BOARDWALK ELEVATION

SHT -

1:50 @ A3

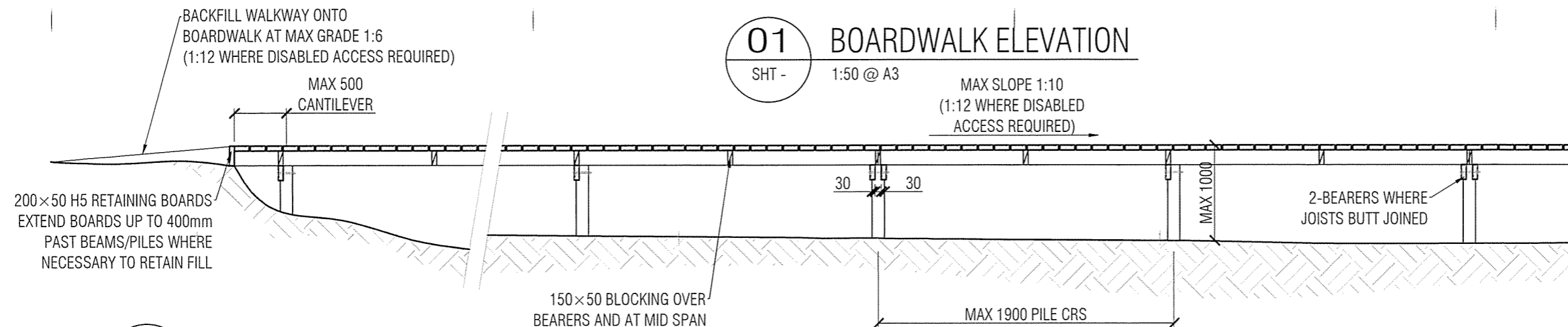
MAX SLOPE 1:10  
(1:12 WHERE DISABLED  
ACCESS REQUIRED)

05

## JOIST HANGER FIXING

SHT -

1:20 @ A3 (ALTERNATIVE FIXING DETAIL)

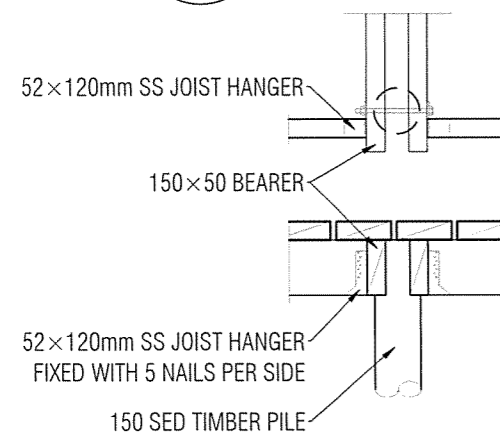

04

## TYPICAL SECTION

SHT -

1:20 @ A3

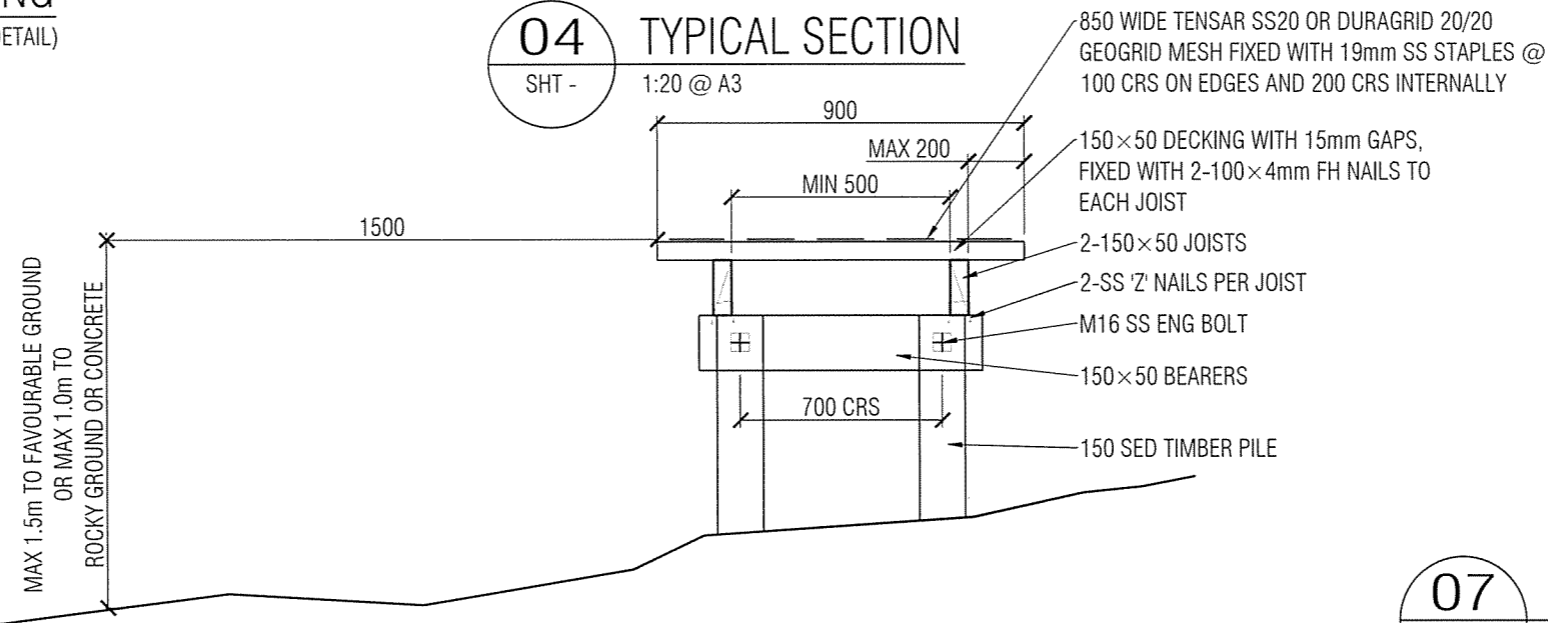

## NOTES:

1. A BUILDING CONSENT IS REQUIRED FOR THE STRUCTURE IF THE FALL HEIGHT IS GREATER THAN 1.5m.
2. ENSURE BEARING CAPACITY OF POST HOLE IS GREATER THAN 100kPa.

02

## FOUNDATION DETAIL

SHT -

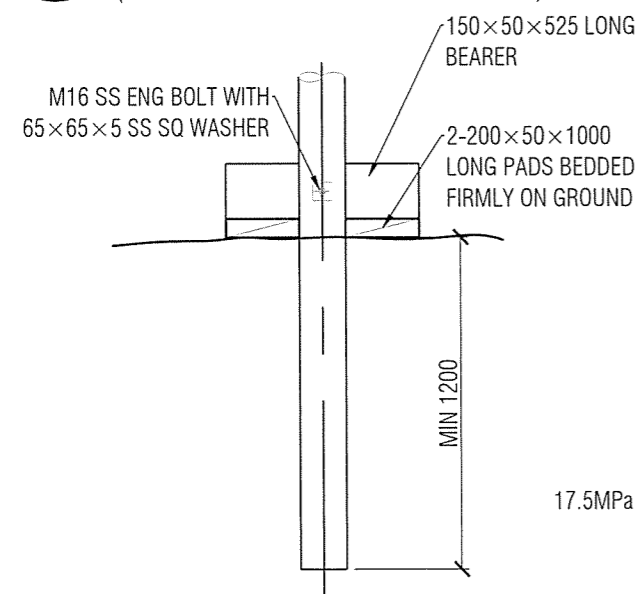
1:20 @ A3  
(FOR MARINE ESTUARY OR SWAMPY GROUND)

03

## FOUNDATION DETAIL

SHT -

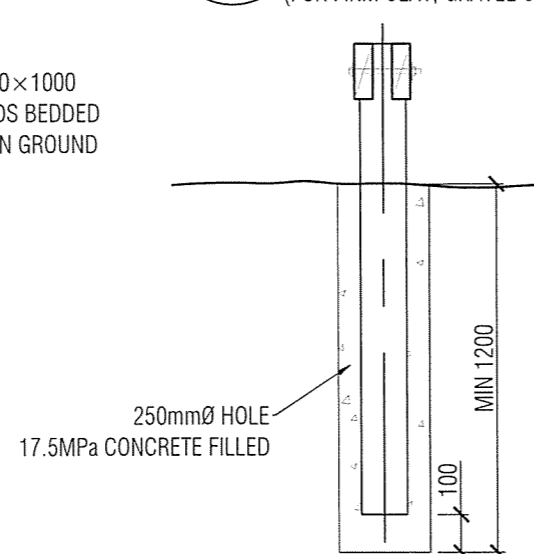
1:20 @ A3  
(FOR FIRM CLAY, GRAVEL OR SAND CONDITIONS)

06

## KERB ELEVATION

SHT -

1:20 @ A3

(REQUIRED ON BOARDWALKS WITH DISABLED ACCESS)

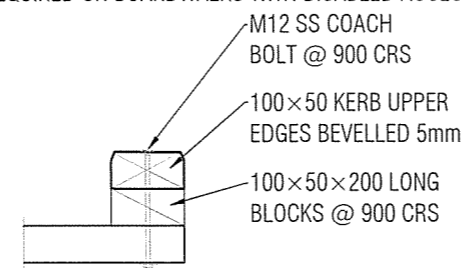

07

## CURVE DETAIL

SHT -

1:20 @ A3

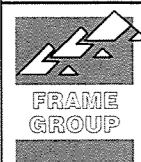
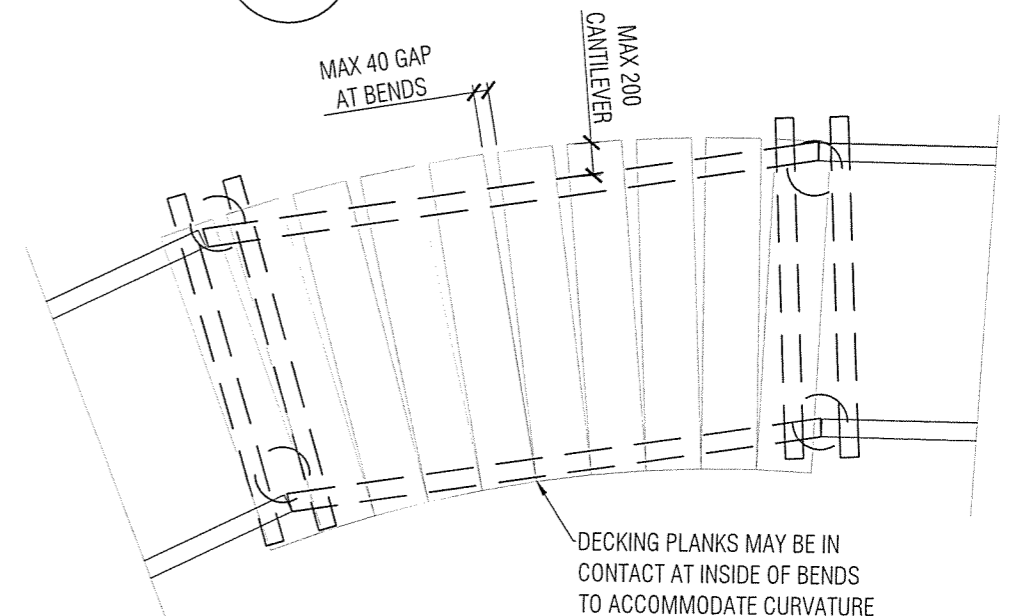

## Frame Group Limited

PO BOX 147211, PONSONBY, AUCKLAND 1144  
LEVEL 2, 16 COLLEGE HILL, AUCKLAND, NZ  
PHONE: 09 638 7221  
© FRAME GROUP LTD, 2017

PREPARED FOR

Absolutely Positively  
Wellington City Council  
Me Heke Ki Pāneke

PROJECT

STANDARD DRAWINGS

TITLE

900 WIDE LOW BOARDWALK  
DETAILS

SCALE

AS SHOWN

DATE

DECEMBER 2017

DRAWN

JR

DESIGNED

TB

FGL JOB

06/113

APPROVED

DRAWING

17/096 SHT 05

REV

DO NOT SCALE

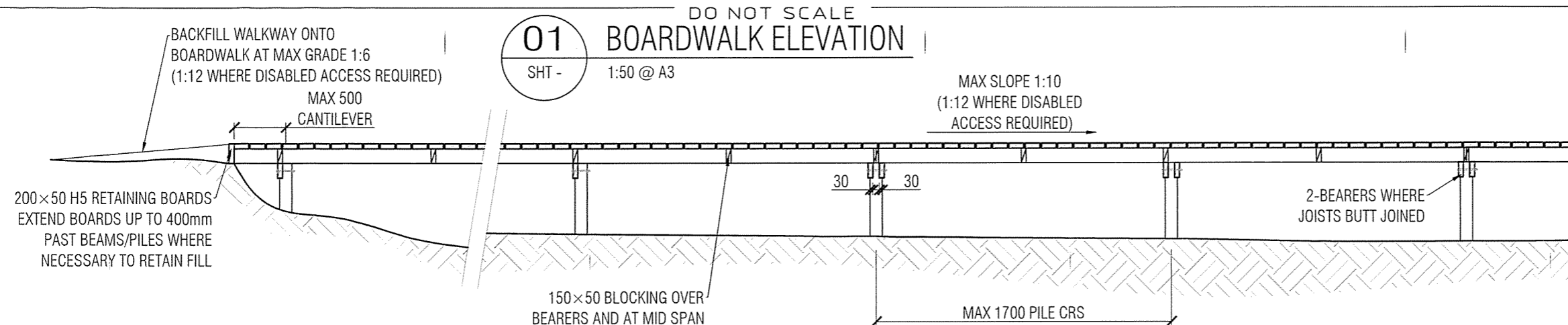

| Rev   | Date        | Amendment |
|---|-------------|-----------|
|   |             |           |
| THIS STRUCTURE IS DESIGNED IN ACCORDANCE WITH THE NZS HANDBOOK SNZ HB 8630:2004 "TRACKS AND OUTDOOR VISITOR STRUCTURES" |             |           |
| DESIGN DETAILS  |             |           |
| SITE USER GROUP   | UR, SST, DV |           |
| STRUCTURE TYPE  | ACCESS      |           |
| DECK DESIGN LOAD  | 3.2 kPa     |           |
| EFFECTIVE FALL HEIGHT   | MAX 1.5m    |           |

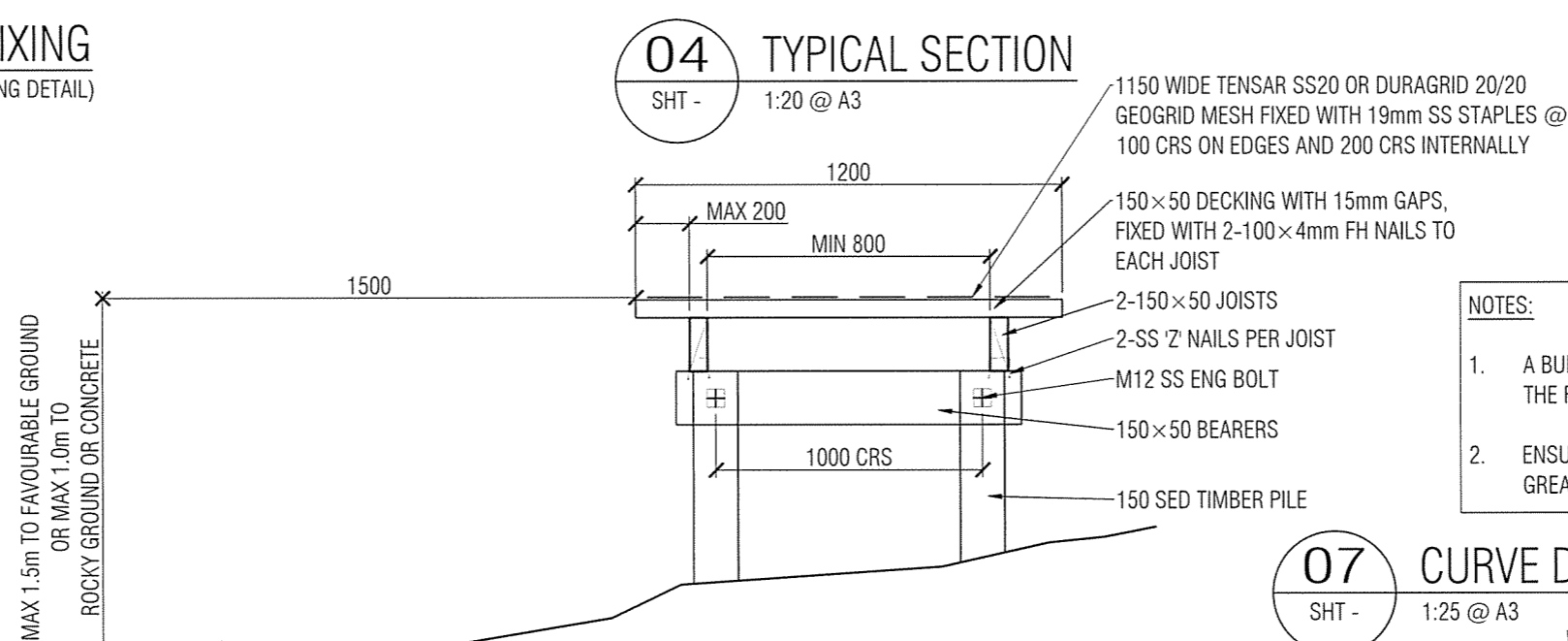
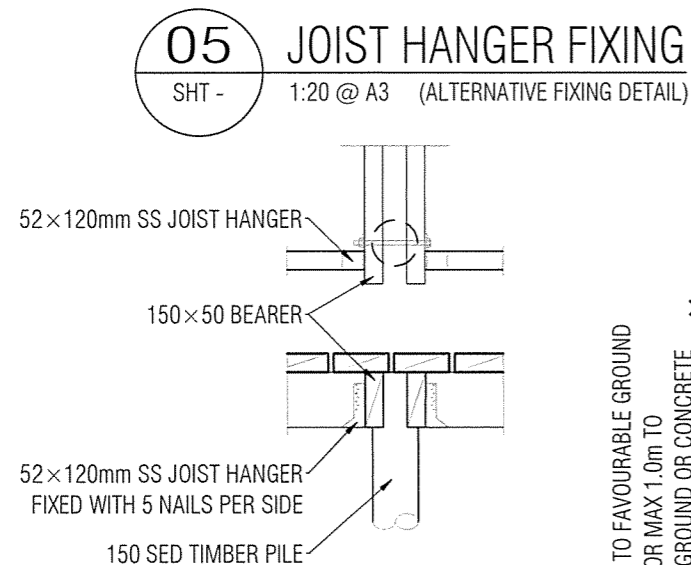

- NOTES:
- A BUILDING CONSENT IS REQUIRED FOR THE STRUCTURE IF THE FALL HEIGHT IS GREATER THAN 1.5m.
  - ENSURE BEARING CAPACITY OF POST HOLE IS GREATER THAN 100kPa.

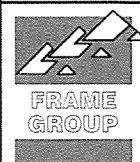
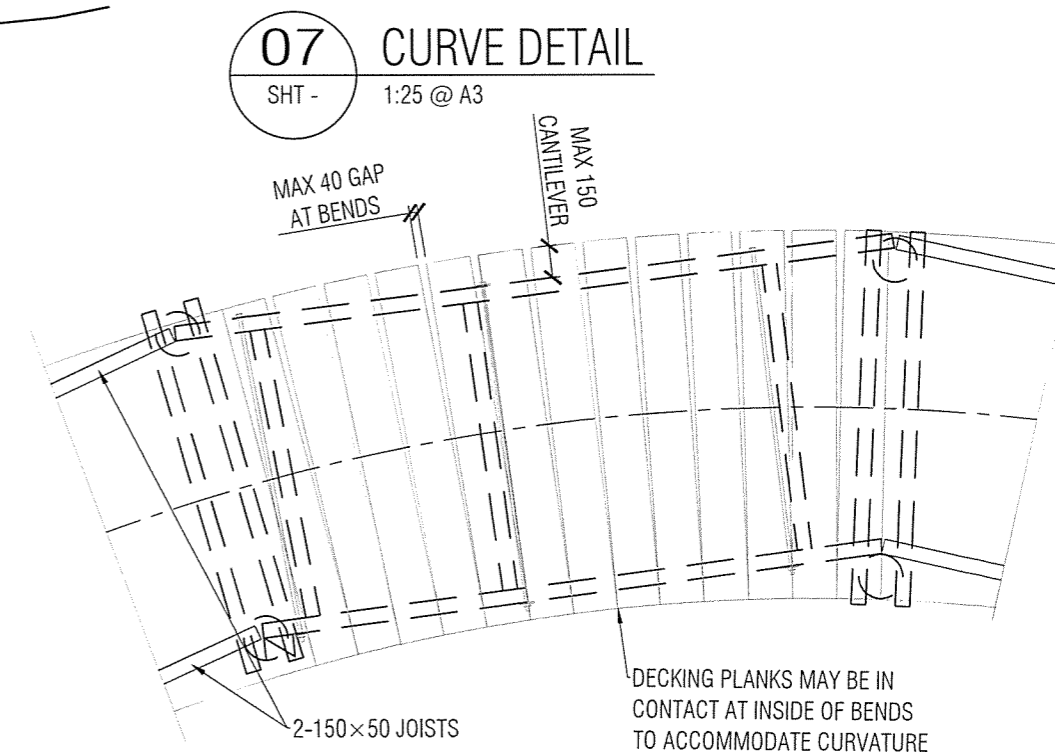
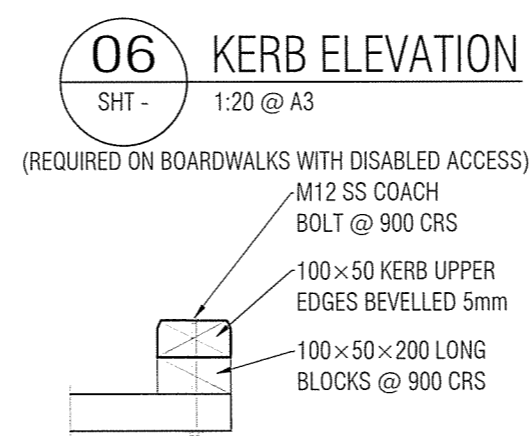
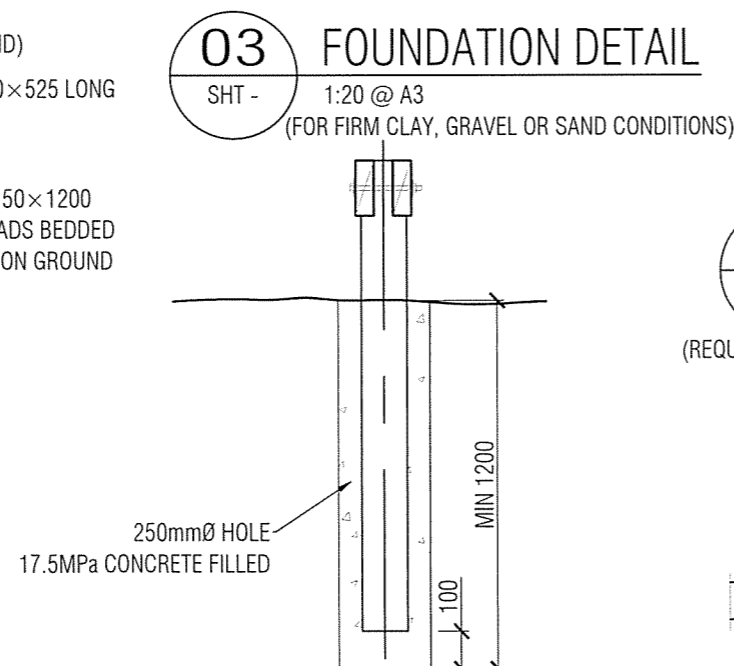
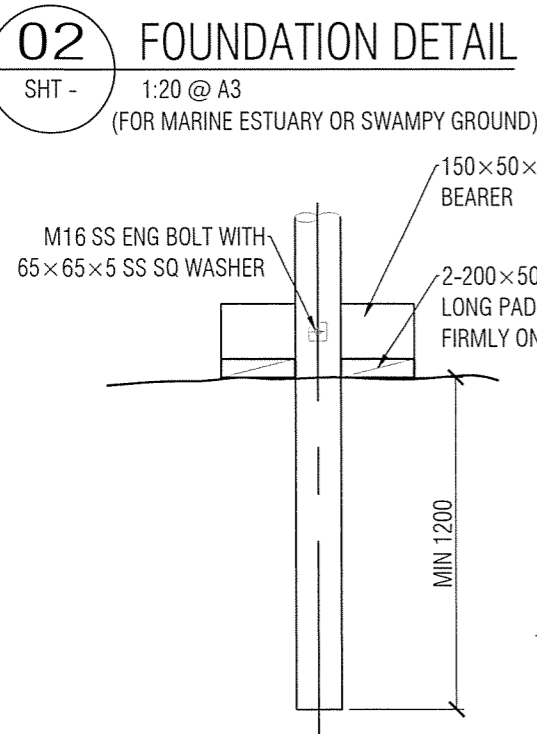

## Frame Group Limited

PO BOX 147211, PONSONBY, AUCKLAND 1144  
LEVEL 2, 16 COLLEGE HILL, AUCKLAND, NZ  
PHONE: 09 638 7221  
© FRAME GROUP LTD, 2017

PREPARED FOR

Absolutely Positively  
Wellington City Council  
Me Heke Ki Pōneke

PROJECT

STANDARD DRAWINGS

TITLE

1200 WIDE LOW BOARDWALK  
DETAILS

SCALE

AS SHOWN

DATE

DECEMBER 2017

DRAWN

JR

DESIGNED

TB

FGL JOB

06/113

APPROVED

DRAWING

17/096 SHT 06

REV

DO NOT SCALE

DO NOT SCALE

# 01 BOARDWALK ELEVATION

SHT - 1:50 @ A3

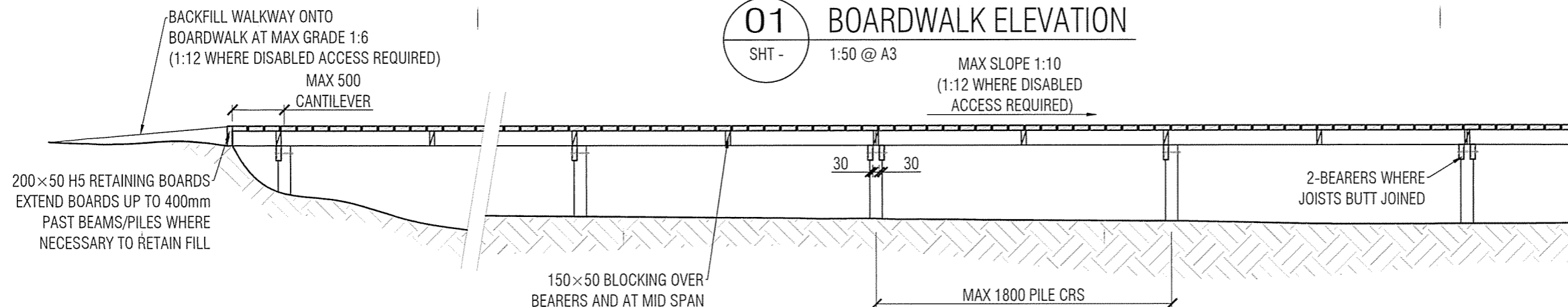

## 05 JOIST HANGER FIXING

SHT - 1:20 @ A3 (ALTERNATIVE FIXING DETAIL)

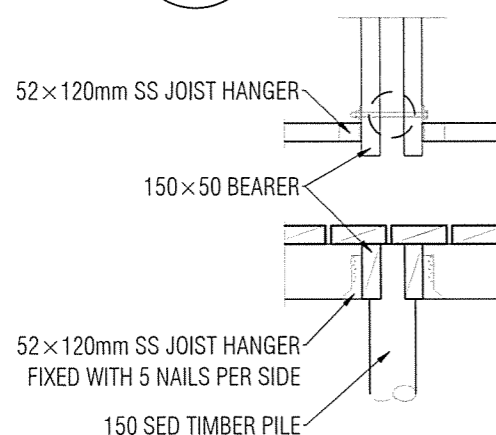

## 04 TYPICAL SECTION

SHT - 1:20 @ A3

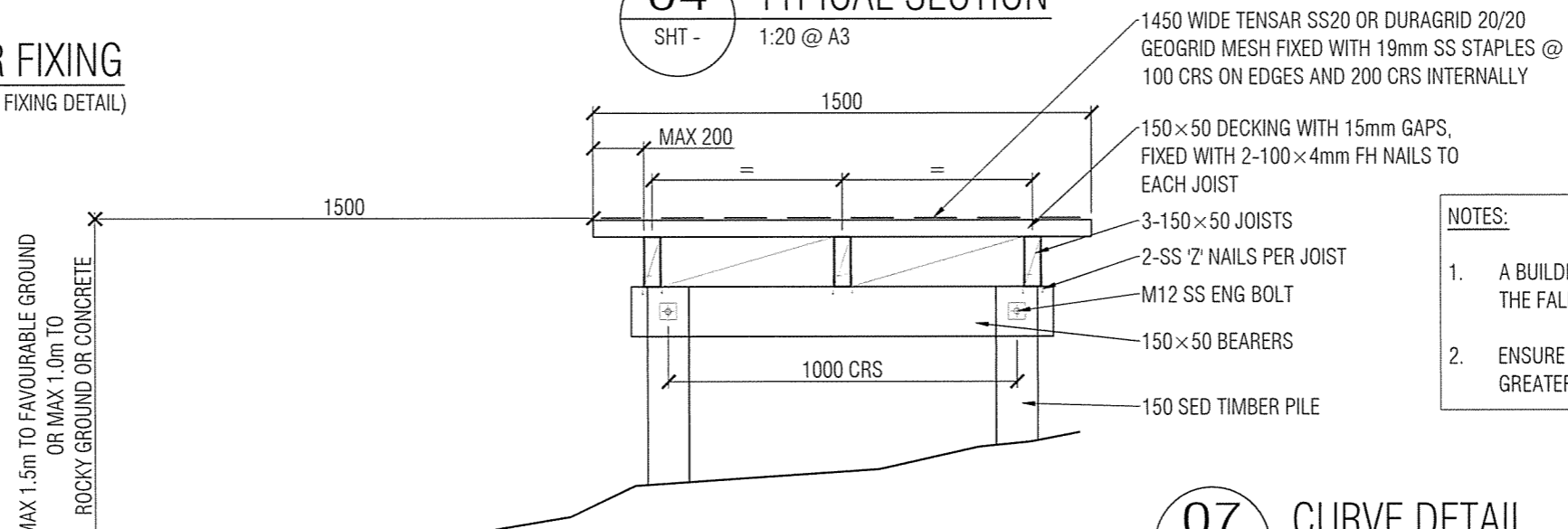

- NOTES:
- A BUILDING CONSENT IS REQUIRED FOR THE STRUCTURE IF THE FALL HEIGHT IS GREATER THAN 1.5m.
  - ENSURE BEARING CAPACITY OF POST HOLE IS GREATER THAN 100kPa.

## 02 FOUNDATION DETAIL

SHT - 1:20 @ A3 (FOR MARINE ESTUARY OR SWAMPY GROUND)

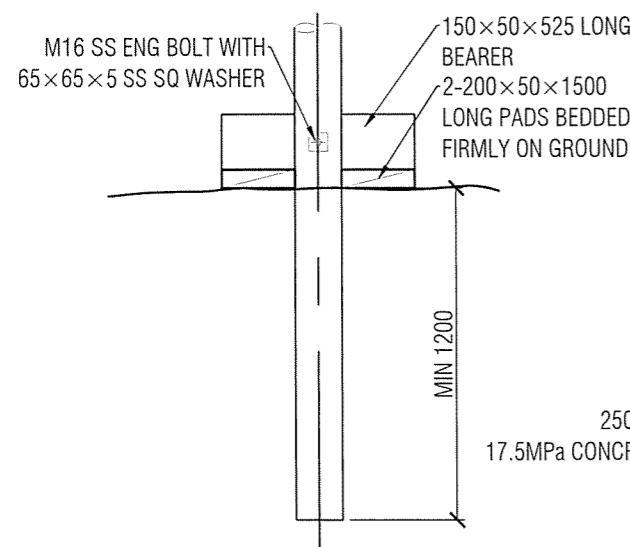

## 03 FOUNDATION DETAIL

SHT - 1:20 @ A3 (FOR FIRM CLAY, GRAVEL OR SAND CONDITIONS)

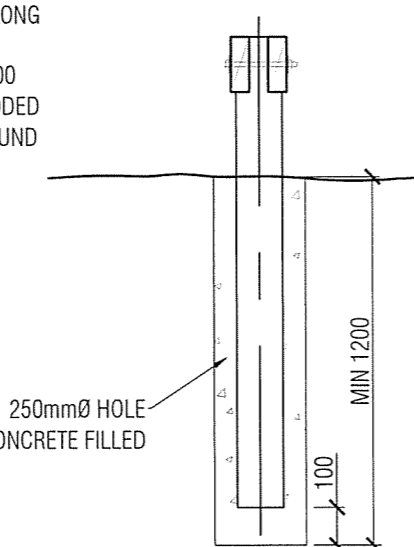

## 06 KERB ELEVATION

SHT - 1:20 @ A3

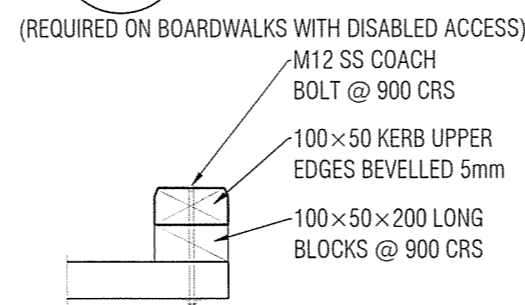

## 07 CURVE DETAIL

SHT - 1:25 @ A3

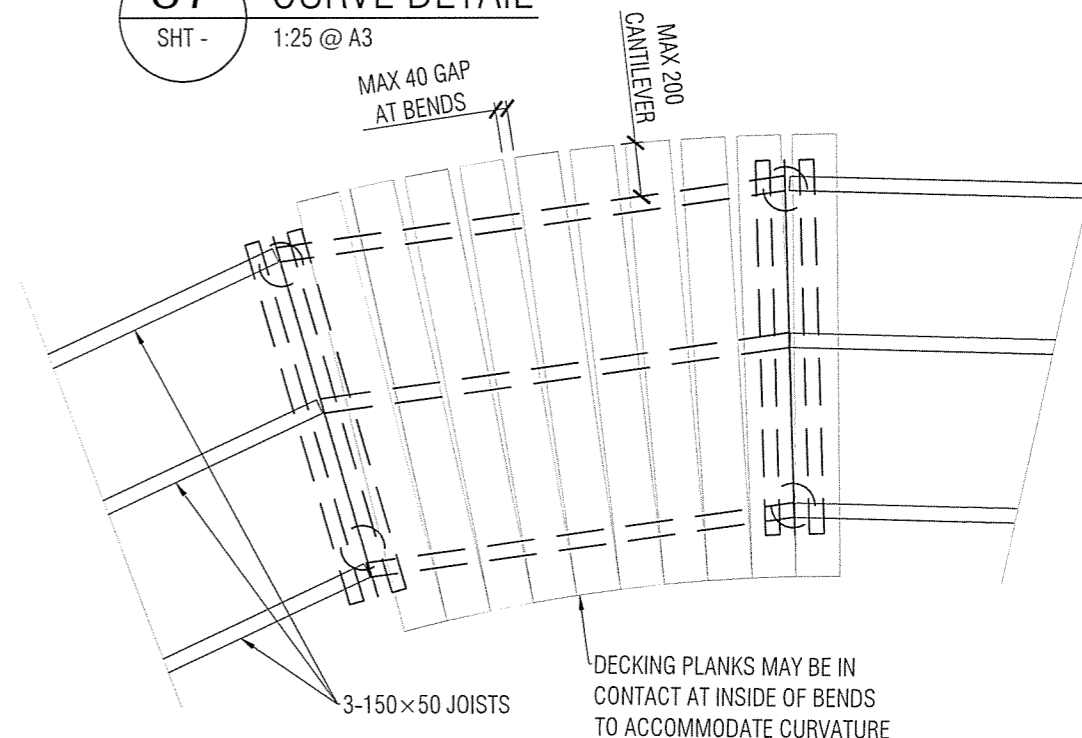

| Rev   | Date        | Amendment |
|---|-------------|-----------|
|   |             |           |
| THIS STRUCTURE IS DESIGNED IN ACCORDANCE WITH THE NZS HANDBOOK SNZ HB 8630:2004 "TRACKS AND OUTDOOR VISITOR STRUCTURES" |             |           |
| DESIGN DETAILS  |             |           |
| SITE USER GROUP   | UR, SST, DV |           |
| STRUCTURE TYPE  | ACCESS      |           |
| DECK DESIGN LOAD  | 3.2 kPa     |           |
| EFFECTIVE FALL HEIGHT   | MAX 1.5m    |           |

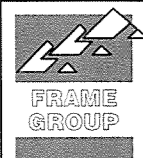

### Frame Group Limited

PO BOX 147211, PONSONBY, AUCKLAND 1144  
LEVEL 2, 16 COLLEGE HILL, AUCKLAND, NZ  
PHONE: 09 638 7221  
© FRAME GROUP LTD, 2017

PREPARED FOR  
**Absolutely Positively**  
Wellington City Council  
Me Hoko Ki Pōneke

PROJECT

STANDARD DRAWINGS

TITLE

1500 WIDE LOW BOARDWALK  
DETAILS

|               |          |          |               |
|---------------|----------|----------|---------------|
| SCALE         | AS SHOWN | DATE     | DECEMBER 2017 |
| DRAWN         | JR       | DESIGNED | TB            |
| APPROVED      | DRAWING  |          | REV           |
| 17/096 SHT 07 |          | 06/113   |               |

DO NOT SCALE

| Rev | Date | Amendment |
|-----|------|-----------|
|     |      |           |

# 01 ELEVATION

SHT - 1:20 @ A3

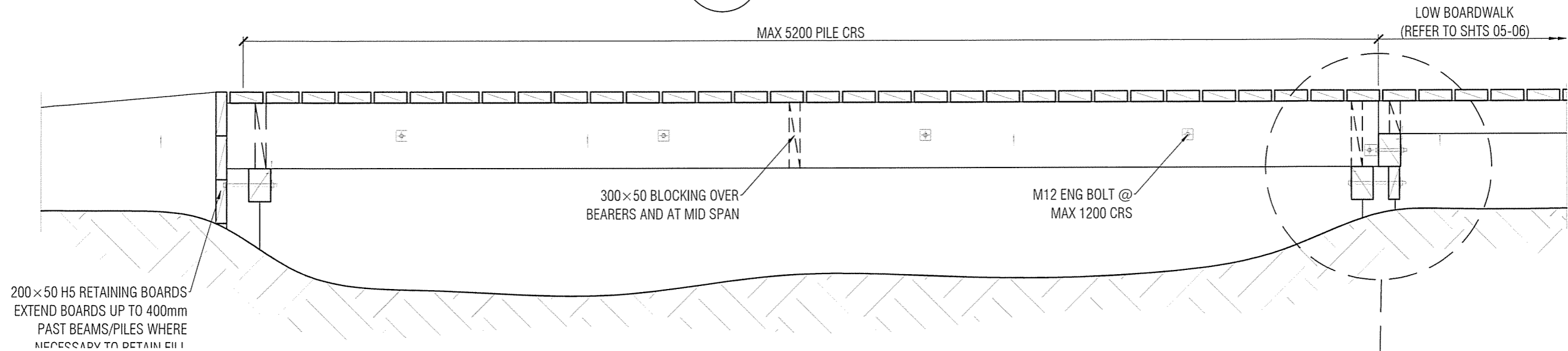

# 02 TYPICAL SECTION

SHT - 1:20 @ A3

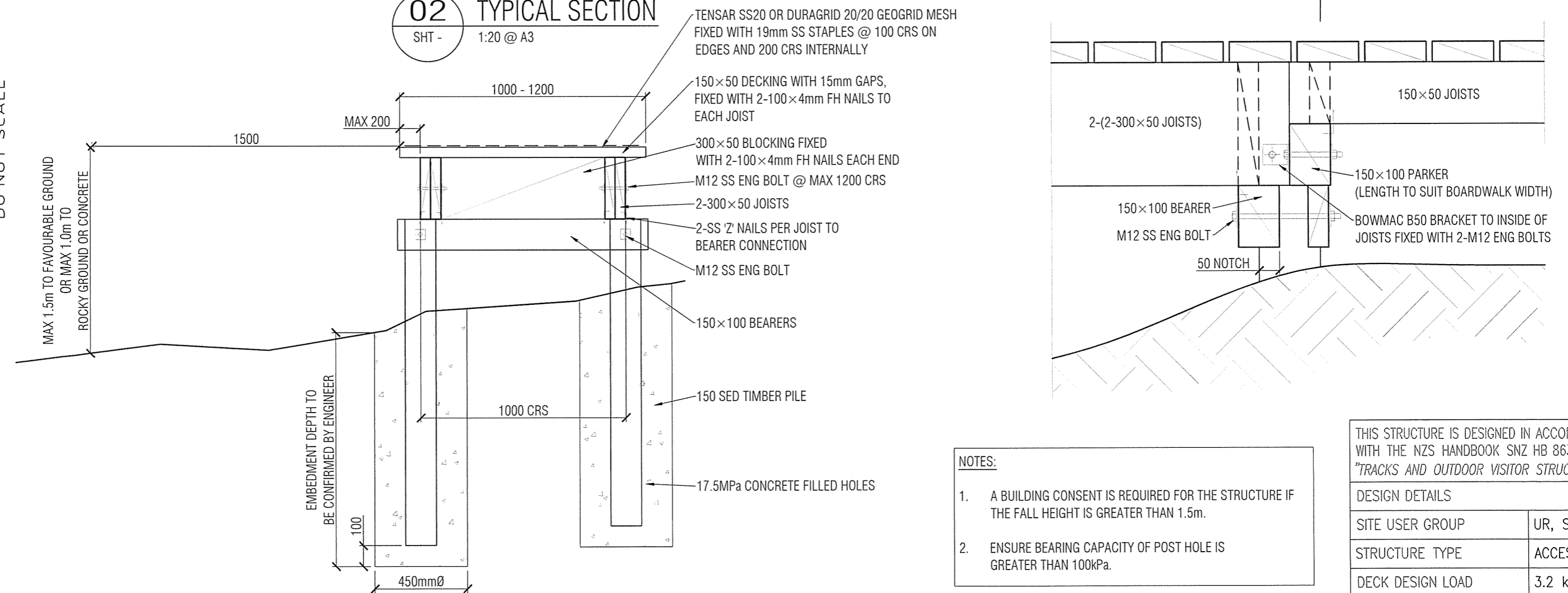

## NOTES:

- A BUILDING CONSENT IS REQUIRED FOR THE STRUCTURE IF THE FALL HEIGHT IS GREATER THAN 1.5m.
- ENSURE BEARING CAPACITY OF POST HOLE IS GREATER THAN 100kPa.

THIS STRUCTURE IS DESIGNED IN ACCORDANCE WITH THE NZS HANDBOOK SNZ HB 8630:2004 "TRACKS AND OUTDOOR VISITOR STRUCTURES"

## DESIGN DETAILS

|                       |             |
|-----------------------|-------------|
| SITE USER GROUP       | UR, SST, DV |
| STRUCTURE TYPE        | ACCESS      |
| DECK DESIGN LOAD      | 3.2 kPa     |
| EFFECTIVE FALL HEIGHT | MAX 1.5m    |

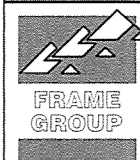

## Frame Group Limited

PO BOX 147211, PONSONBY, AUCKLAND 1144  
LEVEL 2, 16 COLLEGE HILL, AUCKLAND, NZ  
PHONE: 09 638 7221  
© FRAME GROUP LTD, 2017

PREPARED FOR

Absolutely Positively  
Wellington City Council  
Me Heke Ri Pōneke

PROJECT

## STANDARD DRAWINGS

TITLE

## 5.2m LOW BOARDWALK SPAN DETAILS

SCALE

AS SHOWN

DATE

DECEMBER 2017

DRAWN

JR

DESIGNED

TB

FGL JOB

06/113

APPROVED

DRAWING

17/096 SHT 08

REV